

Manual Permanent Magnetic Chuck

Manual permanent magnetic chuck is a kind of new product of magnetic chuck, Adopt brand new workmanship. There are two types of the permanent magnetic chuck, general type (GX series) is applied to grinding machine and facing machine, strong type (SX series) is applied to and milling machine and CNC, Holding force is 10-15 kg/cm². It is suitable for machining high precision workpiece, sheet workpiece and mould.



Rectangle Chuck

Multi-pole magnetic plates have high magnetic properties. Weike multi-pole magnetic plate are intended for installation and fixing components made of ferromagnetic materials on machine tools. Plates are made of neodymium magnet whose main advantage compared with other magnetic materials are high magnetic properties with substantially smaller dimensions and weight. During operation, the force of the magnetic field remains unchanged, thus maintaining high precision grinding. Due to the small pole distance can be processed very small and fine details. Compared with electromagnetic plates, the permanent magnetic plates have the following advantages:

GX SERIES

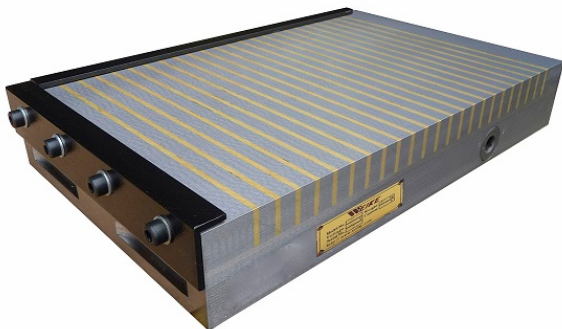

SX SERIES



- No need connect to energy supply;

- Provide absolute reliability and safety of operation;
- Retain the basic specifications for the entire service life. Cross-location advantages;
- A layer thickness of 1.5 mm and 3 - steel; 1 and 0.5 mm - brass;
- Ideal for very small parts due to small pole distance;
- Have holes for attaching eye bolts;
- Eyebolts for transportation included;
- With pole distance of 1.5 ± 0.5 (marking PMM) - Distance from the pole 3 + 1 (marking PMM3)

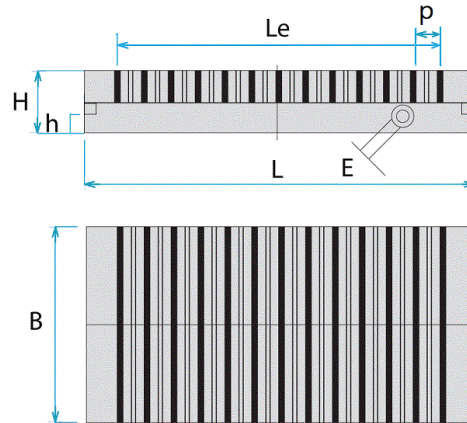

| Model | Length mm | | Width B mm | Height mm | | Holding Force | Handle Hole E | Pole Pitch P mm | Weight kg |
|----------------|-----------|------|---------------|-----------|----|--------------------------|--------------------------|--|--------------|
| | L | Le | | H | h | | | | |
| GX0716 | 160 | 140 | 70 | 45 | 15 | 10 kg/cm ² | 8 mm | 0.5+1.5 Or 1+3 optional | 4 |
| GX1515 | 150 | 130 | 150 | 48 | 16 | | | | 8 |
| GX1530 | 300 | 280 | 150 | 48 | 16 | | | | 16.8 |
| GX1535 | 350 | 330 | 150 | 48 | 16 | | | | 19.6 |
| GX1540 | 400 | 380 | 150 | 53 | 17 | | | | 23.8 |
| GX1545 | 450 | 430 | 150 | 53 | 17 | | | | 26.5 |
| GX2020 | 200 | 180 | 200 | 48 | 16 | | | | 15 |
| GX2040 | 400 | 380 | 200 | 53 | 17 | | | | 31.8 |
| GX2045 | 450 | 430 | 200 | 53 | 17 | | | | 39.5 |
| GX2550 | 500 | 480 | 250 | 58 | 18 | | | | 53.5 |
| GX3060 | 600 | 580 | 300 | 58 | 18 | 77 | | | |
| SX3030 | 300 | 280 | 300 | 60 | 20 | 50 | 15 kg/cm ² | 9 mm | 4+12 |
| SX3060 | 600 | 580 | 300 | 70 | 20 | 80 | | | |
| SX4040 | 400 | 380 | 400 | 70 | 23 | 75 | | | |
| SX4060 | 600 | 580 | 400 | 70 | 23 | 115 | | | |
| SX4080 | 800 | 780 | 400 | 80 | 26 | 200 | | | |
| SX5050 | 500 | 480 | 500 | 80 | 26 | 113 | | | |
| SX6080 | 800 | 780 | 600 | 80 | 26 | 270 | | | |
| SX50100 | 1000 | 970 | 500 | 80 | 28 | 246 | | | |
| SX60120 | 1200 | 1160 | 600 | 80 | 28 | 345 | | | |

Matrix Permanent Magnet Plate

Matrix permanent magnet plate is a kind of new product of magnet chuck, Adopt brand new workmanship. The testing proves it apply to CNC, milling machine and facing machine, Attraction is more than 200n/cm². It is suitable for processing of high precision workpiece, sheet workpiece and mould.

Matrix magnet chuck meets the requirements of the high clamping precision and short adjustment time in CNC and milling machine. The chucks can improve efficiency observably. Constant, even and foreseeable magnetic holding force. Available to change it simply and quickly, bring about 5 sides machining. The workpiece is allowed to exceed the area of working table, generally, it can reduce the assistant time more than 70%-80%.



The super strong magnetic holding force is from the combination of square or strip magnetic units. The units distributes intensively, powerful strength of magnetic fields. It can release the internal stress of workpiece in machining, get the high precision product

1 The magnetic chuck has high precision itself; it can guarantee the precision of workpiece from 2um/100mm. As it doesn't need electricity, the workpiece won't move in no power supply condition. And won't generate heat even for long time using.

2 Distinctive design of magnetic circuit produces super strong and even attraction; high-performance quality magnetic steel holds attraction for long time stability.

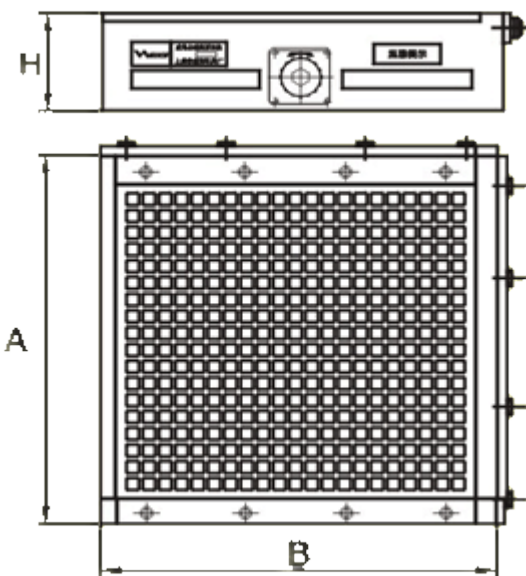

3 Strong attraction come from parallel poles combination, dense distribution of magnetic poles emerges intensive magnetic field. It releases the inner stress of workpieces to improve precision in processing simultaneously.

4 Poles combined as matrix, magnetic bundles are mutually perpendicular, interweave densely, permeate into the bottom of workpiece equality, magnetic bundles are shallow and magnetic circuit densely, it can attract more than 2mm thickness sheet for grinding or milling operation.

| Model | Overall Size mm | | | Square size mm | Pole numbers | Weight KG | Total Holding force KN |
|------------|-----------------|------|-----|----------------|--------------|-----------|------------------------|
| | A | B | H | | | | |
| PMQC-2040 | 200 | 400 | 72 | 18x18 | 105 | 30 | > 25 |
| PMQC-3030 | 300 | 300 | 72 | 18x18 | 132 | 35 | > 25.6 |
| PMQC-3040 | 300 | 400 | 72 | 18x18 | 180 | 45 | > 35 |
| PMQC-3060 | 300 | 600 | 90 | 18x18 | 288 | 72 | > 55 |
| PMQC-4040 | 400 | 400 | 72 | 18x18 | 240 | 65 | > 46.6 |
| PMQC-4050 | 400 | 500 | 90 | 18x18 | 304 | 86 | > 58.2 |
| PMQC-4060 | 400 | 600 | 90 | 18x18 | 384 | 105 | > 69.8 |
| PMQC-5050 | 500 | 500 | 90 | 18x18 | 420 | 113 | > 77.6 |
| PMQC-4080 | 400 | 800 | 110 | 18x18 | 528 | 134 | > 93 |
| PMQC-50100 | 500 | 1000 | 110 | 18x18 | 840 | 220 | >155.2 |
| PMQC-6080 | 600 | 800 | 110 | 18x18 | 792 | 205 | > 139.6 |

Round Chuck

Parallel pole magnetic chuck is widely used for surface grinding machine and linear cutting machine. It also has fine pole and strong type, magnetic force distributes evenly. It performs well on thin and tiny work piece machining without remnant magnetism. The precision of working table doesn't change in magnetizing or demagnetizing. There is no leakage in panel which is specially treated; it prevents corrosion from cutting liquid, increase chuck service life.

Pole pitch 0.5+1.5 mm or 1+3mm for optional. Max uniform clamping force reach to 120N/cm². Best for small and thin workpiece. Low height and light weight. High precision and low remaining magnetism.



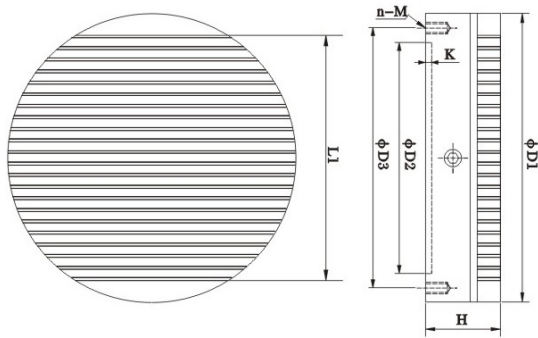

| Model | Diameter D1 mm | Height H mm | L1 mm | D2 mm | D3 mm | n | M | K mm | Weight kg |
|--------|-------------------|----------------|----------|----------|----------|---|----|---------|--------------|
| RX130P | 130 | 50 | 100 | 90 | 115 | 4 | 8 | 4 | 5 |
| RX160P | 160 | 50 | 129 | 120 | 140 | 4 | 10 | 4 | 8 |
| RX200P | 200 | 52 | 169 | 160 | 180 | 4 | 10 | 4 | 12 |
| RX250P | 250 | 52 | 213 | 200 | 230 | 4 | 10 | 4 | 19 |
| RX300P | 300 | 54 | 265 | 250 | 280 | 4 | 12 | 4 | 28 |
| RX400P | 400 | 58 | 360 | 320 | 360 | 6 | 12 | 4 | 57 |
| RX600P | 600 | 62 | 553 | 500 | 540 | 6 | 12 | 5 | 137 |

Radial pole magnetic chuck is usually used for turning or ring-shape grinding.

Its maximum holding force can reach to 180N/cm², Adjustable magnetic force for easy working calibration. Symmetrical and balanced design ensures high speed turning accuracy. Through hole can be drilled in the center for centering and coolant supply. Magnetic padding block can be installed to raise the working surface and grind the inner and outer circle of workpiece.

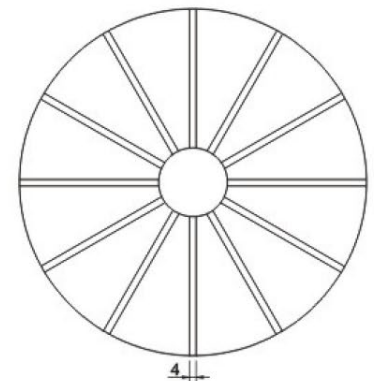
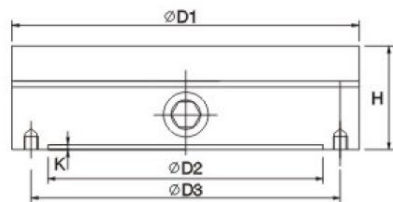

| Model | Diameter D1 mm | Height H mm | D2 mm | D3 mm | n | M | K mm | Weight kg |
|---------------|-------------------|----------------|----------|----------|----|----|---------|--------------|
| RX160R | 160 | 60 | 120 | 140 | 4 | 8 | 4 | 10 |
| RX200R | 200 | 60 | 160 | 180 | 4 | 8 | 4 | 14 |
| RX250R | 250 | 60 | 200 | 235 | 4 | 10 | 4 | 23 |
| RX300R | 300 | 80 | 250 | 270 | 7 | 12 | 4 | 43 |
| RX320R | 320 | 80 | 250 | 270 | 6 | 12 | 4 | 50 |
| RX350R | 350 | 80 | 250 | 280 | 6 | 12 | 4 | 59 |
| RX400R | 400 | 80 | 200 | 260 | 12 | 10 | 6 | 78 |
| RX500R | 500 | 95 | 200 | 300 | 12 | 10 | 8 | 146 |
| RX600R | 600 | 95 | 250 | 350 | 12 | 10 | 8 | 210 |



© 2002 - 2024, Weike Precision Ltd, Shaoxing, China

Technical Changes

The data and illustrations in this catalogue are not binding and only provide an approximate description. We reserve the right to make changes to the product delivered compared with the data and illustrations in this catalogue, e.g. in respect of technical data, design, fittings, material and external appearance.

Weike Precision Machinery Co., Ltd

Cao'e Economic Zone, Shangyu, Zhejiang, China
Tel: 86-575-82566722 Mobile +86-13867501690

info@weikeltd.com

www.syyhjc.com

