

Description

This unit is used as a visual inspection station for operators between SMT machines or board hand unit to link the machines.

Features

- Modular design, PLC controlled
- Stability enhanced by heavy design
- Worktable included by default
- Smooth and parallel width adjustment (stainless steel screws)
- Different lengths available upon request
- Multi- segment concept available upon request
- Automatic/Manual modes
- Variable speed control
- Inspection button
- SMEMA compatible
- Conveyor height 900±20mm



Options

- Anti-dust Covers
- Touch screen
- High-Clearance on request
- Cooling fans on top/bottom for after-reflow
- Light system for better inspection
- Support for Monitor
- Shelf with ESD component boxes
- Motorized/Automatic width adjustment
- Choice of different belt width and chain transport system
- Mechanical stopper
- Foot pedal pass control
- Narrow footprint
- With bottom cabinet

Specifications

Model	Dimension (L*W*H.MM)	PCB size(MM)	Weight(KG)	Remark
S-350C/S-350C-L	500*676*900	50*50-445*350	50KG/55KG	no Lighting/with Lighting
S-460C/S-460C-L	500*786*900	50*50-460*460	65KG/70KG	no Lighting/with Lighting
S-350D/S-350D-L	1000*676*900	50*50-445*350	75KG/80KG	no Lighting/with Lighting
S-460D/S-460D-L	1000*786*900	50*50-460*460	90KG/95KG	no Lighting/with Lighting

Schematic

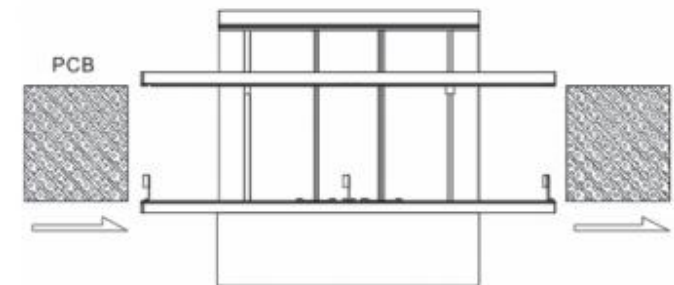

Description

This unit is used to link between production machine or board handing units.

Features

- Increase the use of special thick aluminum
- Accurate and durable stainless steellaser cutting edge oriented
- Smooth parallel to the width of the screw adjustment nethld
- Strengthening the structural design to improve the stability of the equipment
- Anti-static flat belt use 3mm
- SMEMA compatible

Specifications

Model	Dimension (L*W*H.MM)	PCB size(MM)	Weight(KG)	Remark
SH-407C	500*676*900	50*50-445*407	45KG	no Lighting
SH-460C	500*786*900	50*50-460*460	50KG	no Lighting
SH-407D	1000*676*900	50*50-445*407	75KG	no Lighting
SH-460D	1000*786*900	50*50-460*460	85KG	no Lighting



Options

- Anti-dust Covers
- Touch screen
- High-Clearance on request
- Cooling fans on top/bottom for after-reflow
- Light system for better inspection
- Support for Monitor
- Shelf with ESD component boxes
- Motorized/Automatic width adjustment
- Choice of different belt width and chain transport system
- Mechanical stopper
- Foot pedal pass control
- Narrow footprint
- With bottom cabinet

Schematic

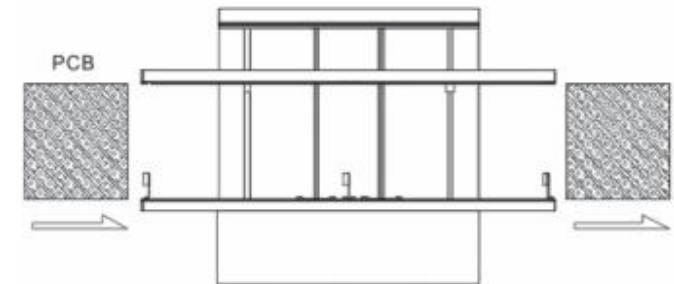

Description

This unit is used to link between SMD machines or board handling units in dual rail PCB assembly lines.

Features

- Modular design
- Stability enhanced by 'robust design'
- Ergonomically designed arm rest
- Smooth and parallel width adjustment
- Width adjustment for individual track can be independently controlled (optional)
- Inspection Mode (optional)
- Two independently controlled belt segment
- Multi-zone concept available upon request
- Different lengths available upon request
- SMEMA compatible

Specifications

Model	Dimension (L*W*H.MM)	PCB size(MM)	Weight(KG)	Remark
SD-350C	500*1046*900	50*50-330*250	80KG	no Lighting
SD-350C	520*1046*900	50*50-330*250	90KG	with Lighting
SD-350D	1000*1046*900	50*50-330*250	95KG	no Lighting



Schematic

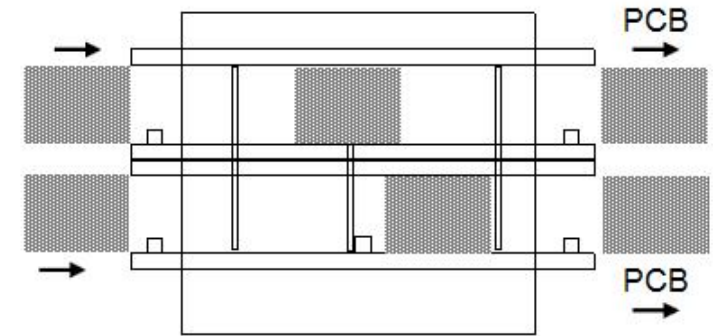

WELCOME INQUIRY

Please visit

www.smthelp.com

Find us more

<https://www.facebook.com/autoinsertion>

Know more our team

<https://cn.linkedin.com/in/smtsupplier>

Welcome to our factory in Shenzhen China

See more machine working video, please Youtube [Auto Insertion](#)

Google

Auto+insertion, to get more informations

Looking forward to your email

info@smthelp.com