



# Through Hole Products

## Pin Inserter S-7000P

- › Single Head to Three Head (Optional)
- › Insertion speeds up to 8,000/hour
- › Lowest cost of ownership in the industry

## Successful case example (Thailand factory) :

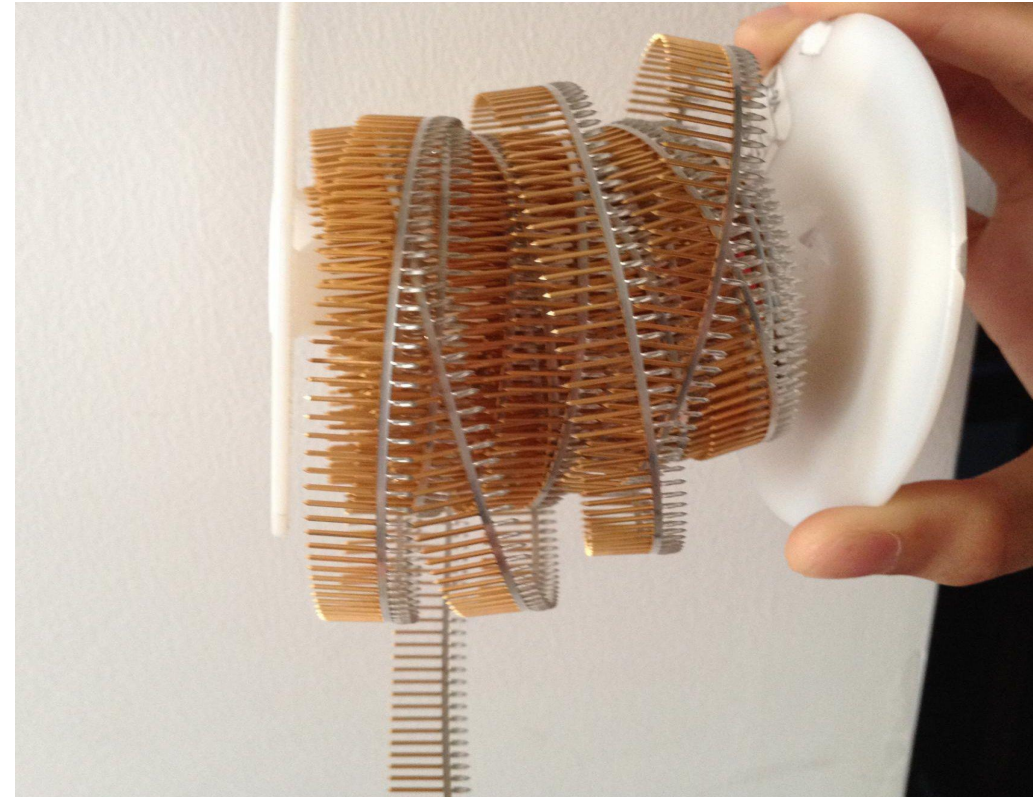
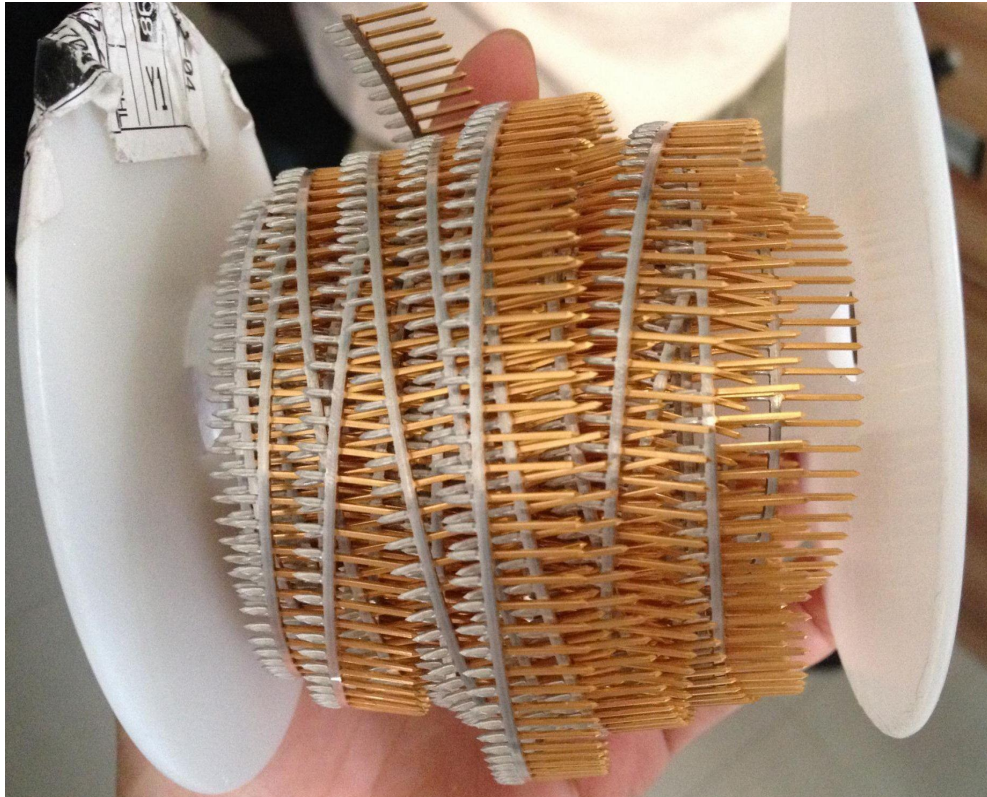

Pin Components



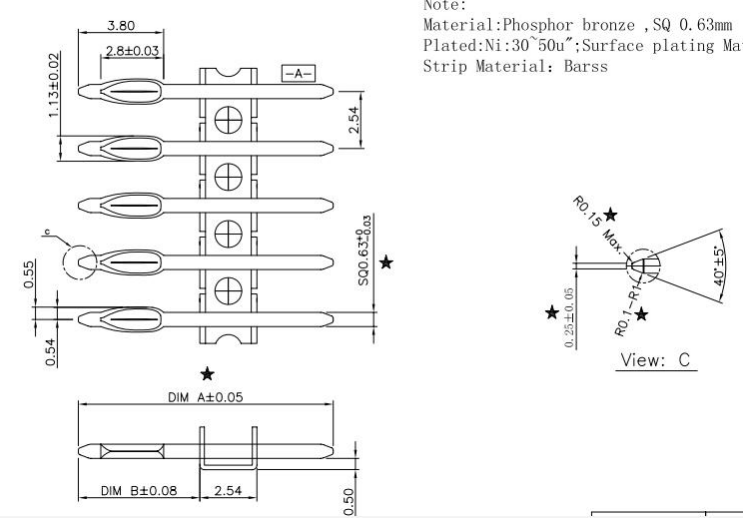
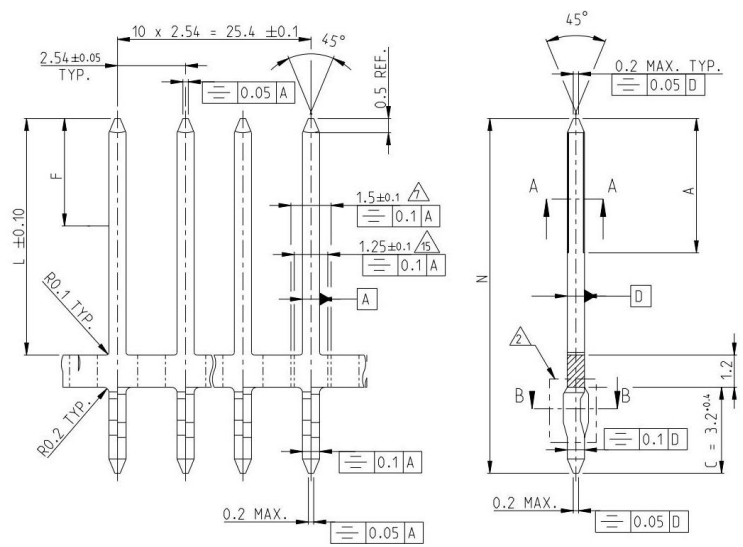

Note:  
 Material: Phosphor bronze, SQ 0.63mm  
 Plated: Ni:30~50u"; Surface plating Mat  
 Strip Material: Barss

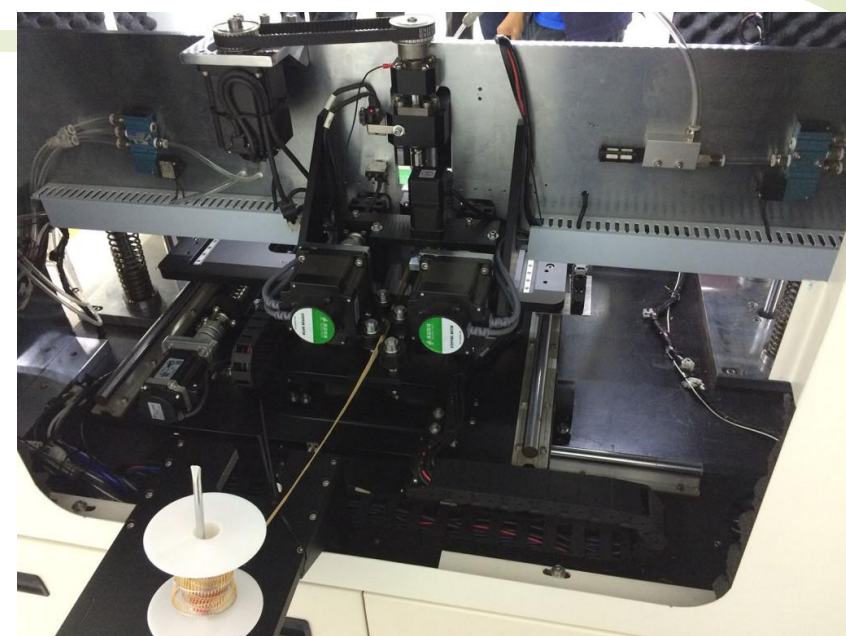

## Pin Inserter S-7000 - In Detail

-Highest Throughput

•8,000 CPH Spec Speed

### -●Insertion Head

• Single Head to three Head (Optional)

- Lowers Cost of Ownership

• Low Energy costs. Power supply: 2.0KVA

•Minimal preventative maintenance required.

RMB2,000/Month/Unit

- Easy to Use User Interface

• Easy operation, use Excel program and USB input.

• Off-line programming available

•Components available: Reel Tape Pin, according to pin's size to special order

• Auto Loader / Unloader PCB.

## S7000 P Pin Insertion Specification Parameter

1	Insertion rate	8000PCS / H
2	Package Types	Reel Tape Pin
3	PCB Size	(Min)50 mm x50mm、(Max)480mm x 390mm
4	Components available	1.2-4.0mm Pin, Round Pin and Tape Pin
5	Insert Head	1 to 3 pcs Heads; Insert different types pin at same time
6	Insert Direction	0-90°, increase 1°.
7	Fixed Mode	Base on customer's technical require
8	Control System	Industrial PC
9	Machine Size (L × W ×H)	2160mm×1330mm×1530mm
10	Machine Weight	1200KG
11	Power supply	220V, AC (single phase) 50/60 HZ, 2KVA;
12	System Protection	UPS, keep machine run 15 minutes without power
13	Working Power	800W (Energy-saving)
14	Air pressure	5-6kg/CM <sup>2</sup>
15	Air consumption	0.6 m <sup>3</sup> /minute
16	Coordinate correction	Machine vision systems, multi-point MARK vision correction.
17	Driving system	AC Servo、 AC motors
18	Data input	USB interface input (EXCEL format)
19	Control System	English version interface (WINDOWS system control platform)LCD monitor
20	Rotary table	Clockwise or anticlockwise
21	PCB transfer mode	Automatic



# Successful case example (Thailand factory) :

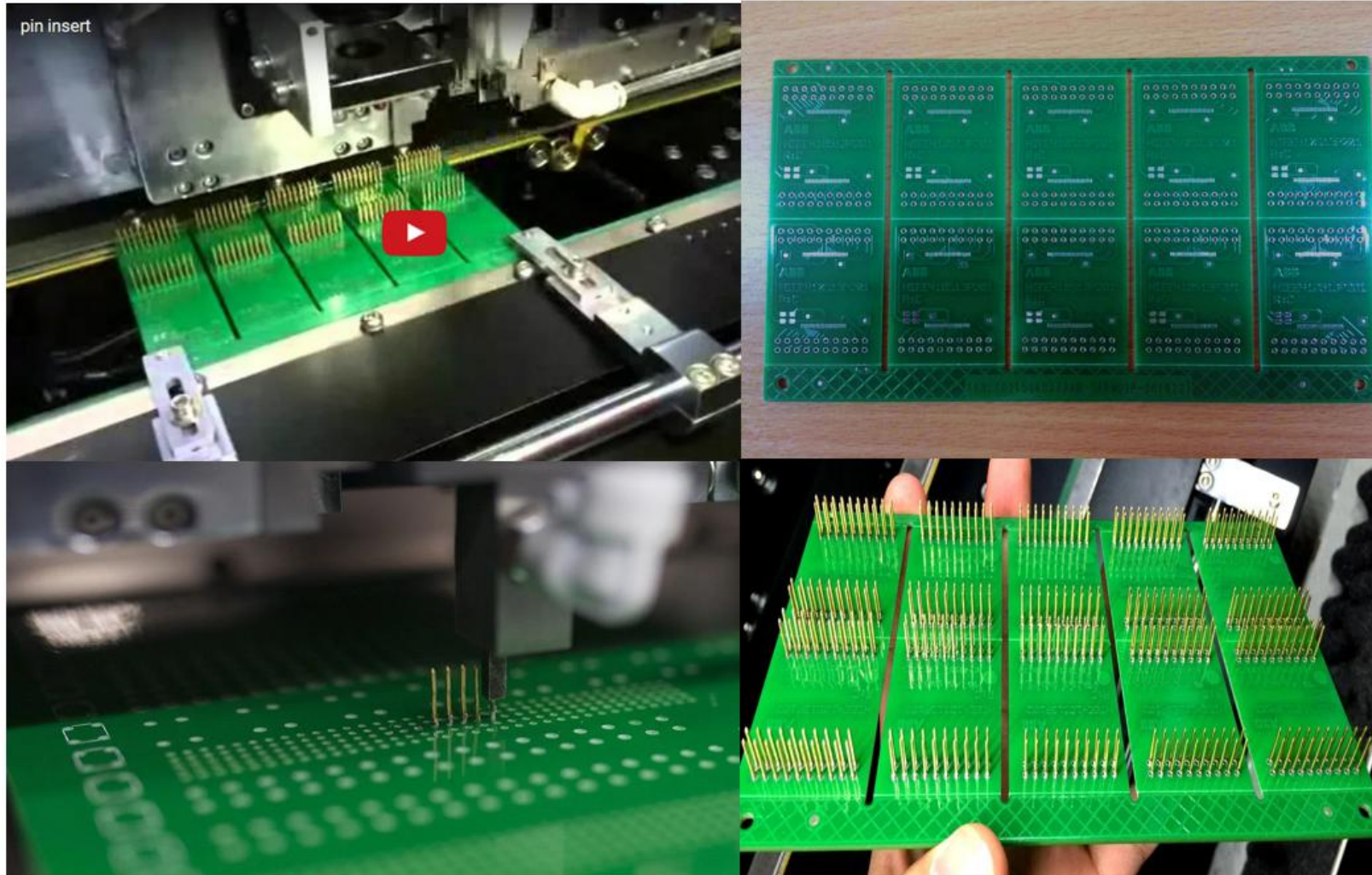

Bare PCB

# Electronics Manufacturing

As the growth of the world economy, the tighter labor markets and product control requires electronic parts processing quality and production speed higher and higher. In order to achieve the electronic assembly automation, According to the needs of odd-form inserter, to insert the packaged or bulk pack component in the hole of PCB accurately need to use machine to replace manual production. But at present most of the odd-form insertion using manual operation, low efficiency, low quality, difficult process, high defective rate&scrapage rate, high manufacturing cost; The imported equipment needs high input cost, returns are very long term, high spare parts and maintenance costs. we hope we can help your esteemed company winning more interests at the lowest cost with maximum efficiency.



Must  
be improved



Labor-intensive mode  
High turnover of staff,  
high wage

full-automatic mode  
stable and reliable performance, efficient





As the growth of the world economy, the tighter labor markets and product control requires electronic parts processing quality and production speed higher and higher. In order to achieve the electronic assembly automation, According to the needs of odd-form inserter, to insert the packaged or bulk pack component in the hole of PCB accurately need to use machine to replace manual production. But at present most of the odd-form insertion using manual operation, low efficiency、low quality , difficult process, high defective rate&scrapage rate,high manufacturing cost; The imported equipment needs high input cost, returns are very long term, high spare parts and maintenance costs. we hope we can help your esteemed company winning more interests at the lowest cost with maximum efficiency.





# 1. Odd Form Insertion Machine Appearance

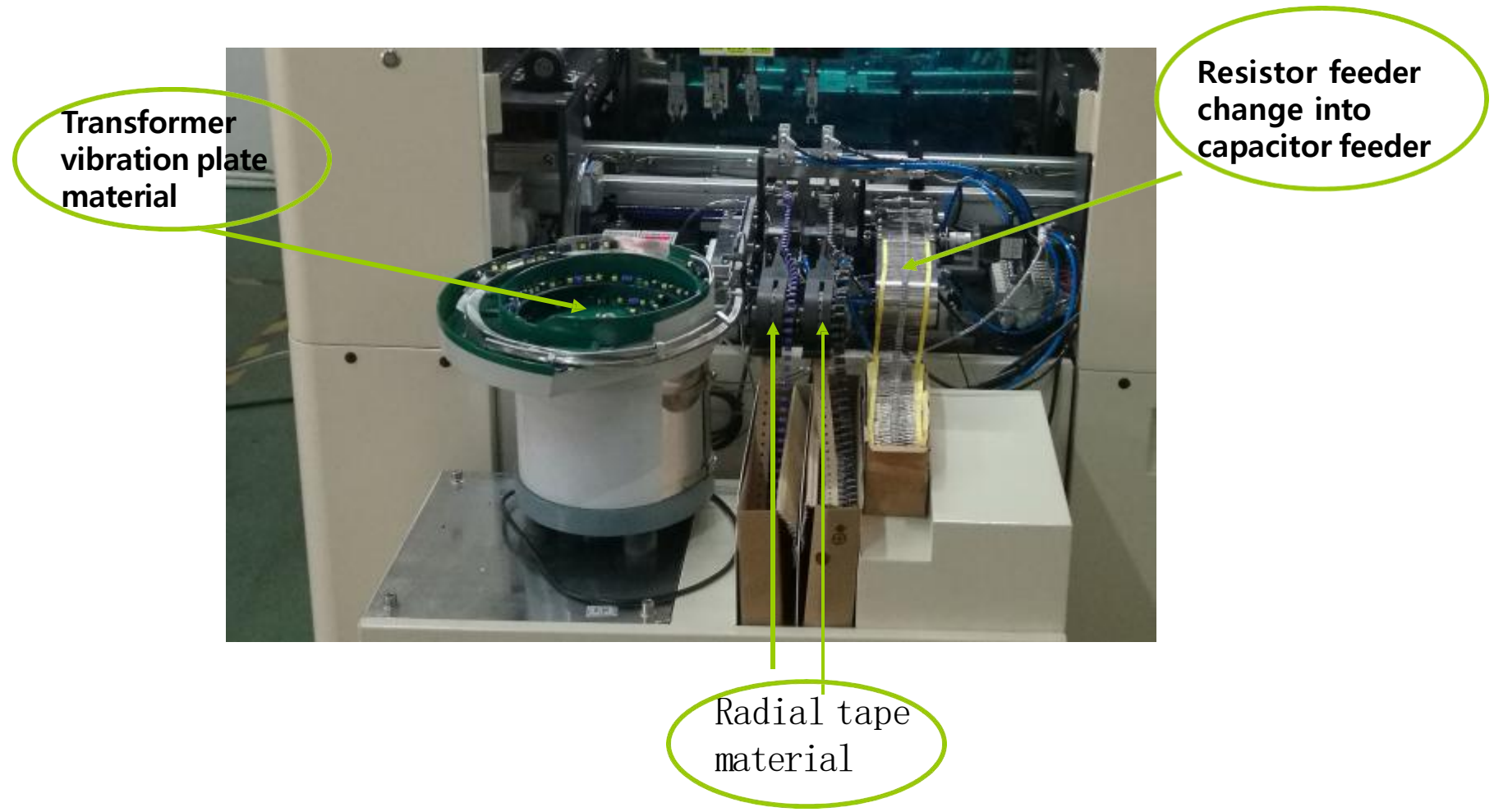

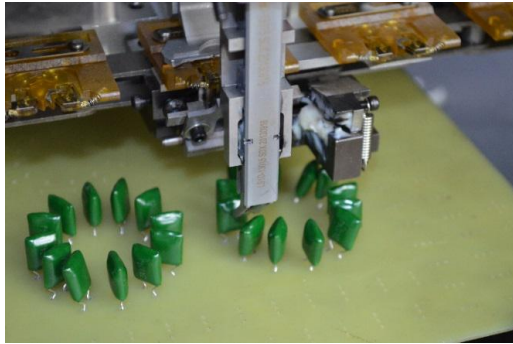

**Radial Insertion Machine**

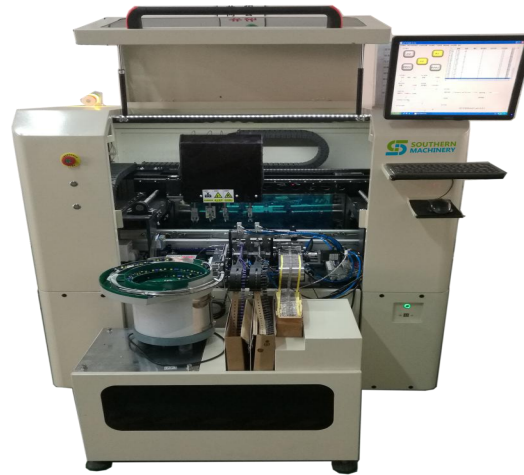
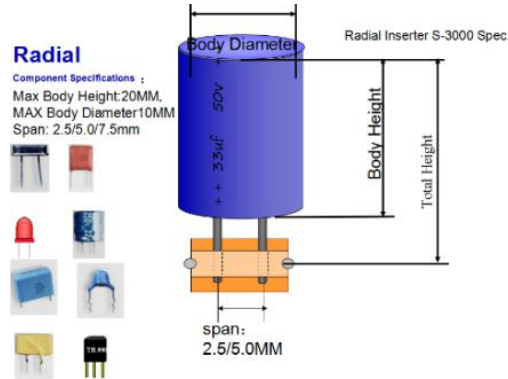

**Odd Form Insertion Machine Appearance**

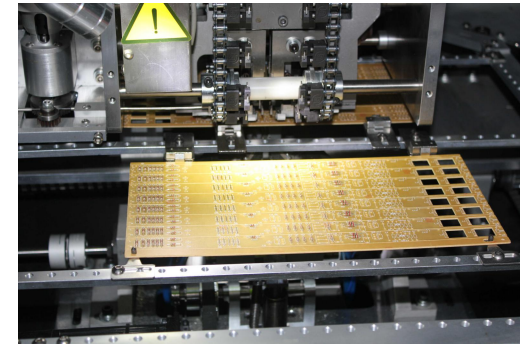
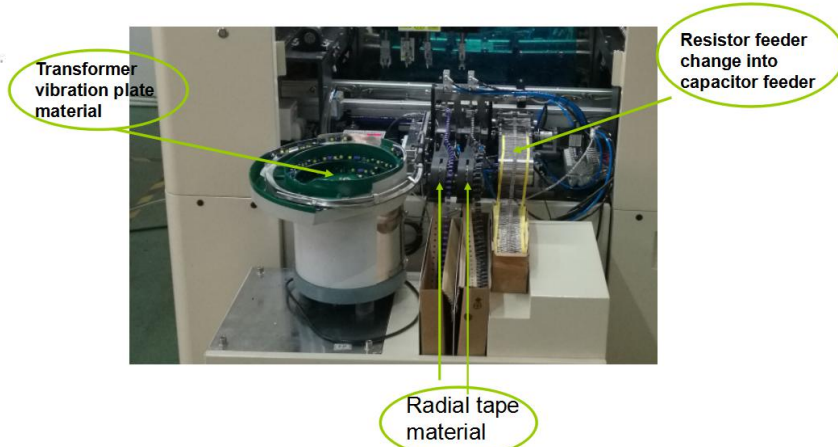

**Axial Insertion Machine**

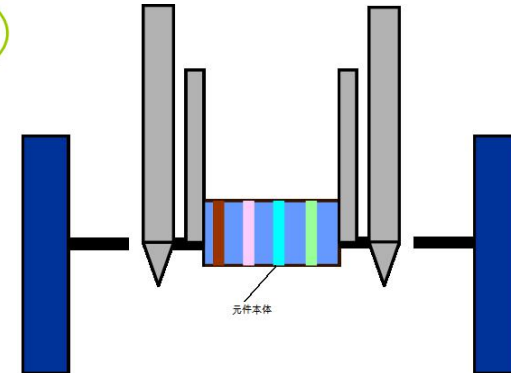



# WELCOME INQUIRY

Please visit

[www.smthelp.com](http://www.smthelp.com)

Find us more

<https://www.facebook.com/autoinsertion>

Know more our team

<https://cn.linkedin.com/in/smtsupplier>

Welcome to our factory in Shenzhen China

See more machine working video, please Youtube [Auto Insertion](#)

Google

Auto+insertion, to get more informations

Looking forward to your email

[info@smthelp.com](mailto:info@smthelp.com)