

SOLAR PANEL PVS-455W/460W-M6H







PERC Monocrystalline solar panel PVS-455W/460W-M6H



Redefined the high-efficiency module series by integrating 166mm silicon wafers with multi-busbar and half-cut cell technologies.

Our panel combined creative technology effectively and extremely improved the module efficiency and power output.

KEY FEATURES:

-  Less mismatch to get more power
-  Less power loss by minimizing the shading impact
-  Competitive low light performance
-  3 times EL test to ensure best quality
-  Ideal choice for utility and commercial scale projects by reduced BoS and improved ROI
-  Outstanding reliability proven by PVEL for stringent Environment condition:
Sand , acid, salt and hail stones
2400Pa wind load and 5400Pa snow load
Anti-PID

Certification:

CE

IEC61215-1-1:2021

IEC61730-1:2018

IEC61730-2:2018

Fire safety Class C

WARRANTY:

Additional value from linear warranty

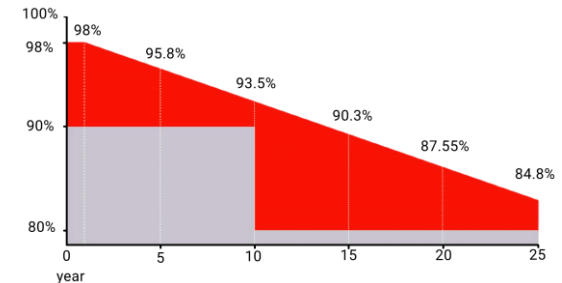

Guarantee on product material and workmanship



Linear power output warranty

SOLAR PANEL PVS-455W/460W-M6H

PERC Monocrystalline solar panel PVS-455W/460W-M6H

Electrical Characteristics:

Module Type	PVS-455W-M6H	PVS-460W-M6H
Maximum Power (Pmp)	455W	460W
Open Circuit Voltage (Voc)	50.13V	50.42V
Short Circuit Current (Isc)	11.23A	11.26A
Maximum Power Voltage (Vmp)	42.45V	42.80V
Maximum Power Current (Imp)	10.72A	10.75A
Module Efficiency at STC(η_m)	20.93%	21.16%
Power Tolerance	(0,+3%)	
Maximum System Voltage	1500VDC	
Maximum Series Fuse Rating	25A	
STC: Irradiance 1000 W/m ² module temperature 25° C AM=1.5 Power measurement tolerance: +/-3%		

SOLAR PANEL PVS-455W/460W-M6H

PERC Monocrystalline solar panel PVS-455W/460W-M6H

Mechanical Specifications:

External Dimensions	2094x1038x35 mm
Weight	24.3 kg
Solar Cells	PERC Mono (144pcs)
Front Glass	3.2mm tempered glass
Frame	Anodized aluminum alloy
Junction Box	IP68, 3 diodes
Output Cables	4.0mm ²
Mechanical Load	Front side 5400Pa Rear side 2400Pa

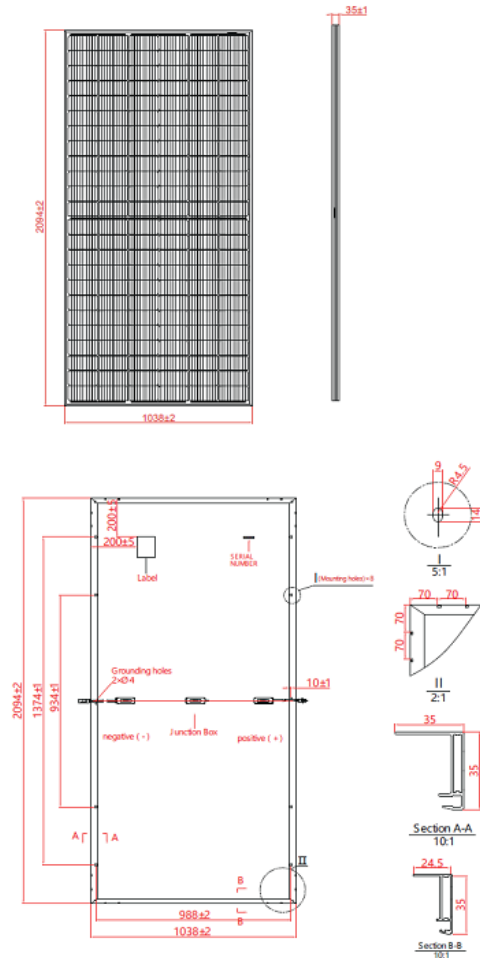

SOLAR PANEL PVS-455W/460W-M6H

PERC Monocrystalline solar panel PVS-455W/460W-M6H

Temperature Characteristics:

Pmax Temperature Coefficient	-0.35 %/° C
Voc Temperature Coefficient	-0.27 %/° C
Isc Temperature Coefficient	+0.05 %/° C
Operating Temperature	-40~+85 ° C
NOCT	45±2 ° C

Packing Configuration:

Container	20'GP	40'HQ
Pieces per Pallet	31	31
Pallets per Container	10	22
Pieces per Container	310	682

I-V Curve

